

SLP020S-12U

High Efficiency Monocrystalline PV Module

- Nominal 12V DC for standard output.
- Outstanding low-light performance.
- Heavy-duty anodized frames.
- High transparent low-iron, tempered glass.
- Designed to withstand high wind pressures, hail and heavy snow.
- Quality aesthetic appearance.

32 CELL
MONOCRYSTALLINE MODULE

20W
POWER OUTPUT

20.00%
MODULE EFFICIENCY

5%
POSITIVE TOLERANCE

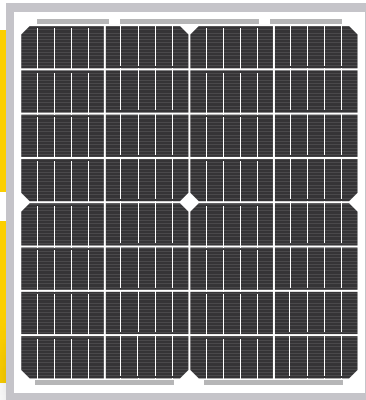

High Efficiency

Module Efficiency improved through advanced cell technology and manufacturing capabilities



High PID Resistance

Advanced cell technology and qualified materials lead to high resistance to PID



Withstands Harsh Environment

High PID resistance
5400 Pa positive load
2400 Pa negative load
Salt mist (IEC 61701)

Performance Warranty

10 years
Product Warranty

25 years
Power Warranty

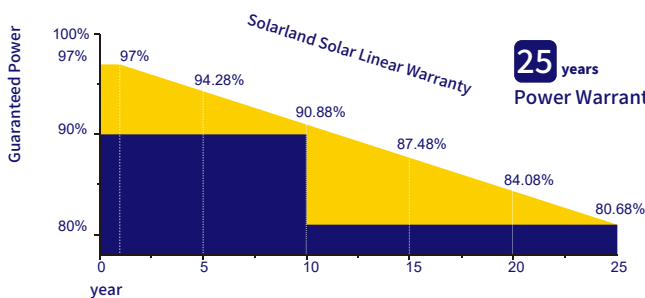

Positive mechanical load >5400Pa
Positive Power Tolerance 0~+5W
Warranty Information 2 Year Product Warranty and Workmanship

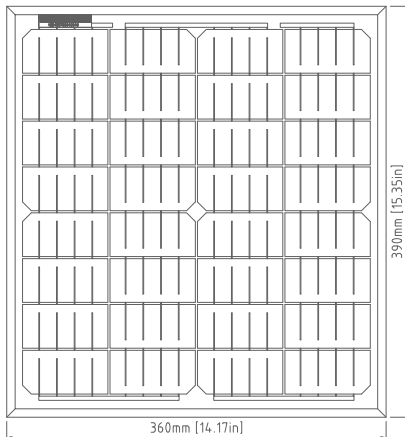

Electrical Characteristics	SLP020S-12U
Product code	020031201A
Maximum power (Pmax)	20W
Voltage at Pmax (Vmp)	18.53V
Current at Pmax (Imp)	1.08A
Open-circuit voltage (Voc)	21.37V
Short-circuit current (Isc)	1.14A
Temperature coefficient of Voc	-(80±10)mV/°C
Temperature coefficient of Isc	(0.065±0.015)%/°C
Temperature coefficient of power	-(0.5±0.05)%/°C
NOCT (Air 20°C; Sun 0.8kW/m² wind 1m/s)	47±2°C
Operating temperature	-40°C to 85°C
Maximum system voltage	600V DC
Power tolerance	± 5%

*STC: Irradiance 1000W/m², AM1.5 spectrum, module temperature 25°C
*NOCT: Nominal operating cell temperature (the data is only for reference)

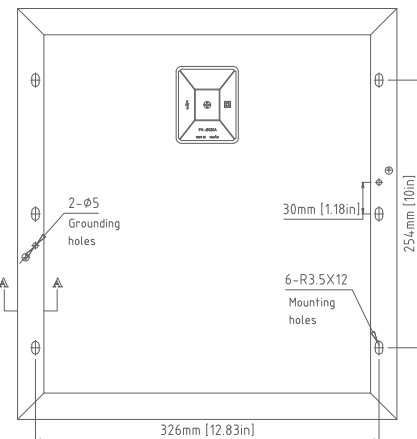

Specifications	SLP020S-12U
Cells	Monocrystalline silicon solar cell
No. of cells and connections	32(4X8)
Module dimension	390mm[15.35in.]x360mm[14.17in.]x30mm[1.18in.]
Weight	1.81kg[4.00lbs]
Packing information(Carton)	440mm[17.32in.]x410mm[16.14in.]x80mm[3.15in.]/(1pc/ctn)

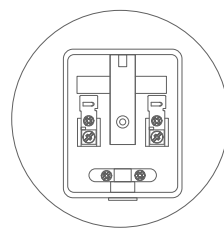

Junction Box
Top View (Lid Open)

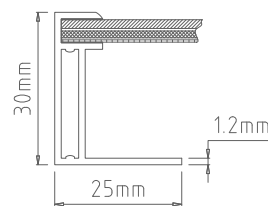

Section A-A

Characteristics

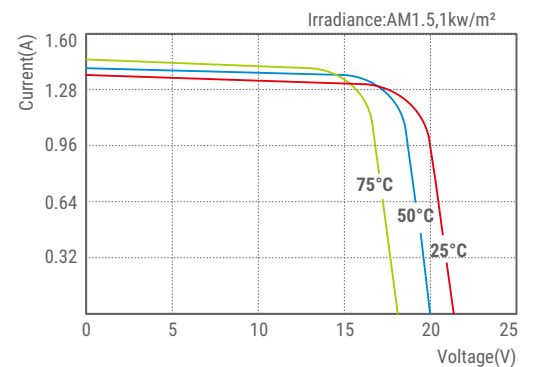

SLP020S-12U I-V Curves

Dimensions in brackets are in inches.
Un-bracketed dimensions are in millimeters.
Unit: mm[in.]